

LOWER CONCOURSE: ROOM DIMENSIONS AND SEATING CAPACITY

Rm	Name	Dimensions	Area †	Height	Theatre	Class Room	Square	U-Shape	Reception	Banquet
1	GRAND BALLROOM	31.5m x 56.8m	1,877.76m ²	5.8m	2,300	1,400	-	-	3,500	1,900
2	GRAND WEST	31.5m x 16.0m	6,466m ²	5.8m	450	228	-	-	700	450
3	GRAND CENTRE	31.5m x 16.6m	515.15m ²	5.8m	650	300	-	-	700	450
4	GRAND EAST	31.5m x 16.1m	500.75m ²	5.8m	624	300	-	-	700	450
5	GRAND EAST (LARGE)	31.5m x 24.3m	758.92m ²	5.8m	900	530	-	-	1,000	700
6	GRAND BALLROOM FOYER	47.8m x 20.5m	508.74m ²	3.4m	-	-	-	-	2,000	-
7	VIDE OFFICE	-	44.13 m ²	-	-	-	Note: Two Window Registration Potential			-
8	VIDE	20.9m x 22.8m	413.98m ²	4.3m	-	-	-	-	-	-
9	SHERATON HALL A	7.8m x 17.3m	127.18m ²	4.4m	120	75	48	42	180	100
10	SHERATON HALL B	8.1m x 17.3m	137.4m ²	4.4m	120	75	48	42	180	100
11	SHERATON HALL C	12.2m x 16.8m	197.05m ²	4.4m	160	108	48	42	200	180
12	SHERATON HALL D	31.3m x 12.8m	235.32m ²	4.4m	-	-	-	-	-	-
13	SHERATON HALL E *	25.5m x 22.5m	546.92m ²	4.4m	624	300	72	66	650	480
14	SHERATON HALL F	8.1m x 21.9m	119.94m ²	4.4m	-	-	-	-	-	-
9-14	SHERATON HALL *	36.83m x 46.76m	1358.24m ²	4.37m	-	Booths (2.4m x 3m): 76		Note: Pillars	1250	950
15	OSGOODE FOYER	8.15m x 14.22m	99.60m ²	2.13m	-	-	-	-	-	-
16	OSGOODE BALLROOM WEST *	20.1m x 16.5m	332.5m ²	4.4m	462	270	72	54	440	270
17	OSGOODE BALLROOM EAST	31.2m x 16.5m	508.83m ²	4.4m	528	324	100	82	650	470
16-17	OSGOODE BALLROOM *	51.6m x 16.5m	841.33m ²	4.4m	990	594	Booths (2.4m x 3m) Note: Pillars		1000	740

CONCOURSE: ROOM DIMENSIONS AND SEATING CAPACITY

Rm	Name	Dimensions	Area †	Height	Theatre	Class Room	Square	U-Shape	Reception	Banquet
-	VIP ROOM	15.0m x 8.7m	132.76m ²	2.7m	70	50	34	30	100	80
-	MEETING PLANNER OFFICE	9.14m x 9.45m	-	-	50	20	20	15	50	-
-	CONVENTION REGISTRATION / CONCOURSE CHECKROOM	13.0m x 9.2m	65.22m ²	3.05m	-	Note: Four Window Registration Potential			-	-
-	CONCOURSE LEVEL	24.08m x 26.21m	559.46m ²	3.0m	-	-	-	-	-	-

† Area refers to useable function space and not exact square footage. Some obstructions may exist. * Please ask for a detailed plan for location of pillars in these rooms.

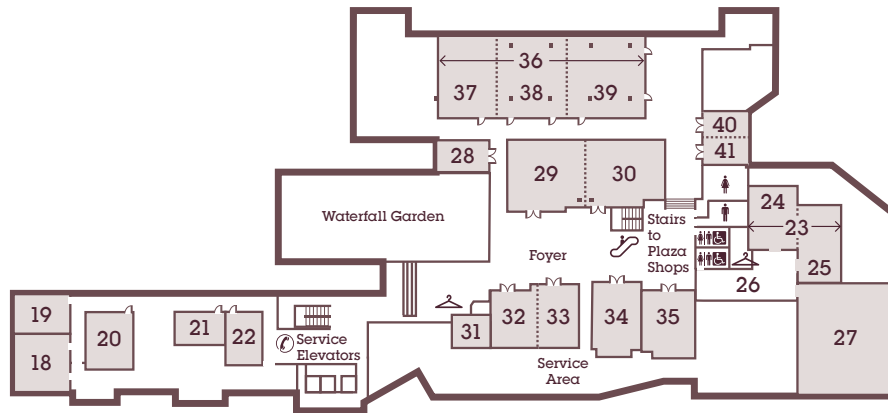

MEZZANINE: ROOM DIMENSIONS AND SEATING CAPACITY

Rm	Name	Dimensions	Area †	Height	Theatre	Class Room	Square	U-Shape	Reception	Banquet
18	YORK	8.8m x 7.6m	66.89m ²	2.5m	68	44	30	26	80	50
19	PEEL	5.7m x 8.1m	44.59m ²	2.6m	40	24	28	19	60	30
20	NORFOLK	7.8m x 5.5m	459m ²	2.5m	40	21	18	12	35	20
21	OXFORD	7.2m x 4.9m	34.19m ²	2.5m	35	18	18	15	35	20
22	CARLETON	5.2m x 7.8m	44.31m ²	2.6m	40	21	18	12	35	20
23	PINE	11.9m x 14.4m	154.59m ²	2.4m	135	80	52	44	150	120
24	PINE WEST	9.5m x 8.1m	76.55m ²	2.4m	80	25	32	24	80	60
25	PINE EAST	12.0m x 6.6m	77.39m ²	2.4m	80	40	32	28	80	60
26	BIRCHWOOD FOYER	17.1m x 7.8m	97.55m ²	2.5m	-	-	-	-	110	-
27	BIRCHWOOD BALLROOM	18.6m x 13.8m	263.94m ²	3.1m	220	150	80	60	220	220
28	OAK	7.6m x 5.0m	39.21m ²	2.5m	-	-	Permanent Boardroom Set Up for 10			-
29	CHESTNUT WEST *	13.2m x 8.9m	104.61m ²	2.8m	90	55	34	25	90	90
30	CHESTNUT EAST *	11.8m x 8.9m	101.54m ²	2.8m	80	55	30	25	85	80
29-30	CHESTNUT WEST & EAST *	24.9m x 8.9m	227.05m ²	2.8m	170	112	60	45	175	170
31	MEZZANINE OFFICE	-	-	-	-	-	Permanent Boardroom Set Up for 10			-
32	MAPLE WEST *	8.8m x 8.1m	68.66m ²	3.2m	50	40	24	15	55	50
33	MAPLE EAST *	9.8m x 6.6m	60.76m ²	3.2m	55	34	16	10	55	40
32-33	MAPLE WEST & EAST *	14.7m x 8.8m	129.41m ²	3.2m	80	60	34	30	110	110
34	LINDEN	11.5m x 8.1m	88.26m ²	2.8m	70	45	34	30	75	70
35	CEDAR	10.6m x 8.6m	87.24m ²	2.8m	75	45	34	30	75	70
	MEZZANINE FOYER	31.4m x 12.8m	370.5m ²	2.5m	-	-	-	-	420	-
36	WILLOW	36.0m x 12.5m	451.32m ²	2.7m	260	210	70	60	-	280
37	WILLOW WEST	7.6m x 12.5m	97.08m ²	2.7m	65	40	30	28	-	80
38	WILLOW CENTRE	16.5m x 12.5m	205.69m ²	2.7m	120	100	46	40	-	120
39	WILLOW EAST	11.9m x 12.5m	148.55m ²	2.7m	85	28	32	32	-	80
40	SPRUCE NORTH	3.8m x 7.5m	28.34m ²	2.5m	15	-	12	-	-	40
41	SPRUCE SOUTH	4.3m x 7.5m	34.0m ²	2.5m	15	-	12	-	-	20
40-41	SPRUCE	6.9m x 7.5m	62.34m ²	2.5m	30	18	18	-	-	40

† Area refers to useable function space and not exact square footage. Some obstructions may exist. * Please ask for a detailed plan for location of pillars in these rooms.

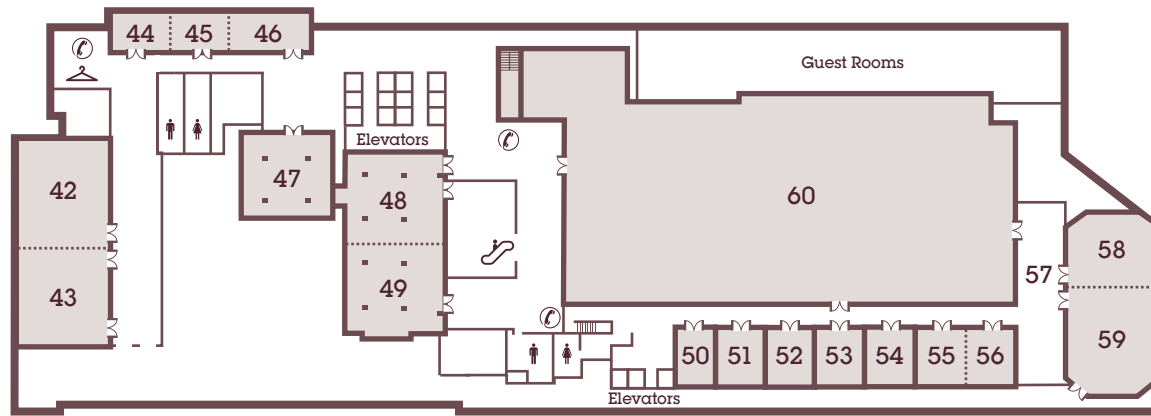

SECOND FLOOR: ROOM DIMENSIONS AND SEATING CAPACITY

Rm	Name	Dimensions	Area †	Height	Theatre	Class Room	Square	U-Shape	Reception	Banquet
42	DOMINION BALLROOM N.	17.7m x 14.8m	266.72m ²	3.4m	250	175	70	60	450	240
43	DOMINION BALLROOM S.	15.6m x 14.8m	233.84m ²	3.4m	200	150	70	56	400	220
42-43	DOMINION BALLROOM	14.8m x 33.8m	500.75m ²	3.4m	650	378	110	-	850	450
44	ROOSEVELT	8.1m x 5.4m	40.13m ²	3.4m	40	21	18	12	35	20
45	MACKENZIE	8.1m x 6.1m	40.13m ²	3.4m	40	21	18	12	35	20
46	CHURCHILL	29.7m x 4.1m	118.54m ²	3.4m	80	50	32	24	80	60
47	CITY HALL * New dimensions	24.4m x 14.5m	219.81m ²	3.5m	135	80	52	44	150	120
48	PROVINCIAL BALLROOM N.	9.3m x 13.4m	169.08m ²	3.3m	160	144	-	-	-	260
49	PROVINCIAL BALLROOM S.	10.7m x 15.9m	124.77m ²	3.3m	72	63	-	-	-	90
48-49	PROVINCIAL BALLROOM	31.8m x 13.4m	424.94m ²	3.3m	190	126	-	Note: Pillars	-	260
50	ELGIN	6.5m x 9.5m	59.64m ²	3.4m	51	30	30	28	50	40
51	WENTWORTH	7.5m x 9.5m	73.58m ²	3.4m	59	40	34	30	60	50
52	KENORA	7.5m x 9.5m	74.23m ²	3.4m	59	40	34	30	60	50
53	HURON	8.1m x 9.5m	74.14m ²	3.4m	59	40	34	30	60	50
54	KENT	8.2m x 9.5m	74.42m ²	3.4m	59	40	34	30	60	50
55	SIMCOE	8.2m x 9.5m	75.34m ²	3.4m	59	40	34	30	60	50
56	DUFFERIN	8.1m x 9.5m	74.51m ²	3.4m	59	40	34	30	60	50
55-56	SIMCOE & DUFFERIN	15.7m x 9.5m	139.54m ²	3.4m	118	70	44	40	110	100
57	CIVIC FOYER	7.8m x 20.7m	1,707m ²	3.1m	-	-	-	-	-	-
58	CIVIC BALLROOM N.	11.7m x 14.2m	159.98m ²	3.6m	150	90	58	42	180	160
59	CIVIC BALLROOM S.	17.7m x 14.2m	250.12m ²	3.6m	276	153	78	62	260	260
58-59	CIVIC BALLROOM	29.7m x 14.2m	408.77m ²	3.6m	450	254	96	88	440	400
60	WATERFALL GARDEN Available for private functions weather permitting.	72.5m x 25.2m	795.25m ²	6.1m	-	-	-	-	350	250

† Area refers to useable function space and not exact square footage. Some obstructions may exist. *Please ask for a detailed plan for location of pillars in these rooms.

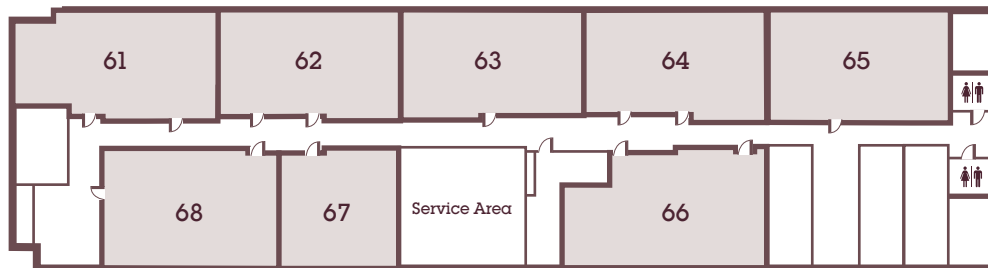

FOURTH FLOOR: ROOM DIMENSIONS AND SEATING CAPACITY

Rm	Name	Dimensions	Area †	Height	Theatre	Class Room	Square	U-Shape	Reception	Banquet
61	LEASIDE	4.6m x 13.5m	64.01m ²	2.8m	46	30	28	25	50	30
62	ROSEDALE	4.8m x 12.2m	60.2m ²	2.8m	42	30	25	22	50	30
63	FOREST HILL	4.5m x 12.2m	62.5m ²	2.8m	42	30	28	25	50	30
64	KENSINGTON	4.8m x 12.2m	60.2m ²	2.8m	42	30	22	20	50	30
65	DANFORTH	4.8m x 11.9m	59.45m ²	2.8m	42	30	25	22	50	30
66	DAVENPORT	7.7m x 13.2m	74.14m ²	2.8m	48	36	32	28	70	50
67	YORKVILLE EAST	7.8m x 7.3m	45.06m ²	2.8m	24	18	15	12	40	20
68	YORKVILLE WEST	5.4m x 11.7m	68.19m ²	2.8m	56	36	30	28	60	50

FORTY-THIRD FLOOR: ROOM DIMENSIONS AND SEATING CAPACITY

Rm	Name	Dimensions	Area †	Height	Theatre	Class Room	Square	U-Shape	Reception	Banquet
-	CLUB BOARDROOM	8.3m x 3.9m	34.28m ²	2.2m	-	-	Permanent Boardroom Set Up for 14		-	-
-	PINNACLE ROOM	13.1m x 4.0m	52.95m ²	2.2m	70	50	40	36	70	50

† Area refers to useable function space and not exact square footage. Some obstructions may exist. * Please ask for a detailed plan for location of pillars in these rooms.

Meeting Facilities

- M Carleton
- 2 Churchill Foyer
- 2 Churchill
- 2 City Hall
- 2 Civic Ballroom
- 2 Civic Foyer
- M Maple West
- M Maple East
- M Linden
- M Cedar
- 4 Davenport
- 2 Dominion Ballroom
- 2 Dominion Foyer
- 2 Dufferin
- 2 Elgin
- M Birchwood Ballroom
- M Birchwood Foyer
- 4 Forest Hill
- LC Grand Ballroom
- LC Grand Ballroom Foyer
- 2 Huron
- 2 Kenora
- 4 Kensington
- 2 Kent
- 4 Leaside
- 2 Mackenzie
- M Norfolk
- L Office
- LC Osgoode Ballroom
- LC Osgoode Foyer
- M Oxford
- M Peel
- 2 Provincial Ballroom
- 2 Roosevelt
- 4 Rosedale
- LC Sheraton Hall A-F
- 2 Simcoe
- M Spruce North
- M Spruce South
- 4 Yorkville East
- 4 Yorkville West
- C Vide
- C VIP Room
- 2&M Waterfall Garden
- 2 Wentworth
- M Willow East
- M Willow Centre
- M Willow West
- M Pine East
- M Pine West
- M York

Hotel Services

- L Arrival Court
- C ATM
- L Baggage Room
- L Bell Desk
- L FedEx Business Centre
- C Convention Registration
- C Currency Exchange
- C Food Court
- L Front Desk
- L Quinn's Steakhouse
- L Link @ Sheraton
- L Lobby Cafe
- C Parking (City Hall Underground Lot)
- C PATH Underground Network
- C PSAV Audio Visual Services
- LC Receiving/Loading Dock
- C Security
- L&C Sheraton Shops
- L SPG/Club Reception
- L BnB (Breakfast 'n' Bistro)
- L Tour Desk
- L Valet Parking
- LC Vide Office
- C VIP Room
- 2&M Waterfall Garden

Service Symbols

- \$ ATM
- ☂ Coatcheck
- 🍽 Food Court
- 🅇 Parking (City Hall Lot)
- 🍴 Restaurants
- 🚿 Washrooms
- ♿ Wheelchair Accessible Elevator

4TH FLOOR

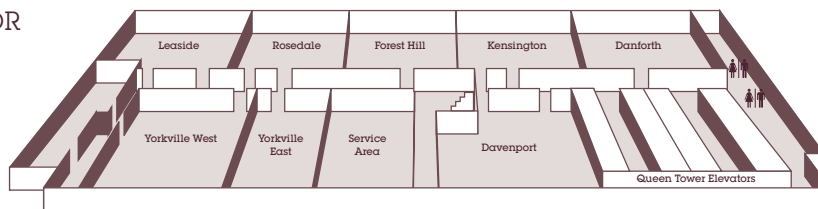

2ND FLOOR

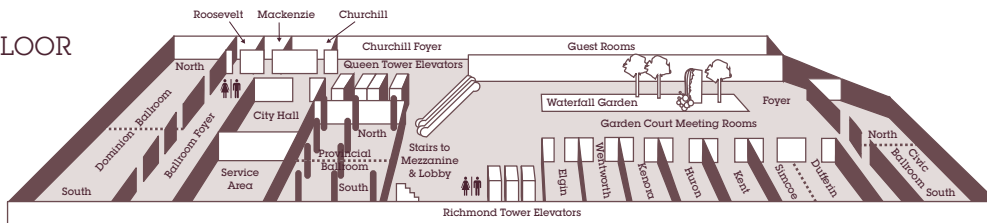

MEZZANINE

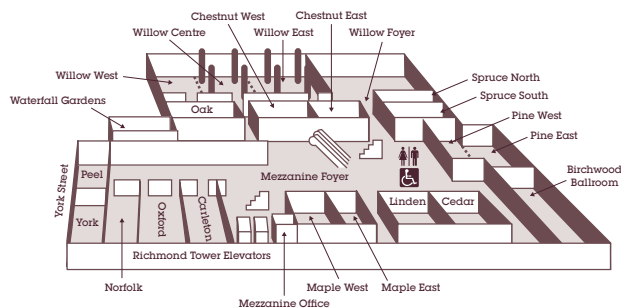

LOBBY

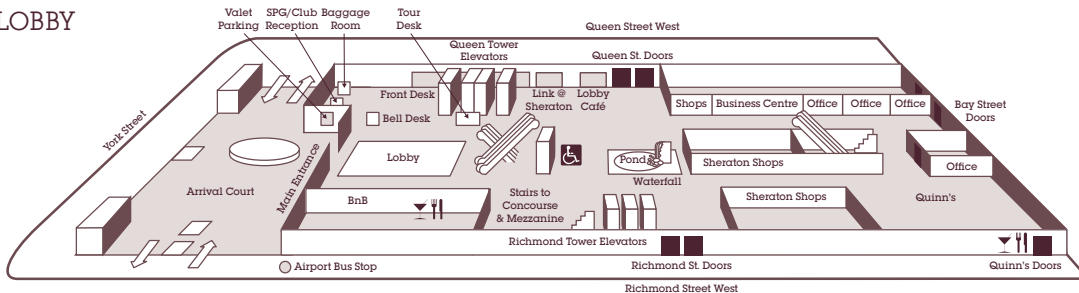

CONCOURSE

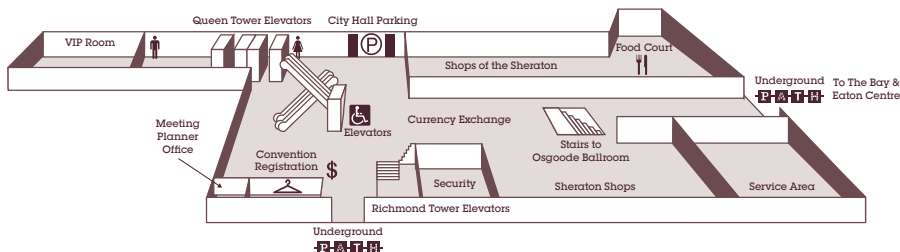

LOWER CONCOURSE

